

# GREEN & ENVIRONMENT AUDIT REPORT 2017-18

Date 04/05/18 to 09/05/18

## **1. Aim & objective**

- a) Beautification of college campus.
- b) Boosting plantation programme and gardening.
- c) Practical education regarding pollution to the students of Biological science
- d) Environment survey regarding pollution to the students of Biological science.
- e) Keeping idea of clearness.

## **2. Location of the college**

Gopalpur College, Gopalpur, Balasore

Mouza- Sarangpur Po-Jageswer pada

Via- Gopalpur Ps- Khantapara, Dist- Balasore

State- Odisha

Plot no. 06- (1 acre) , Plot no-07 (81 decimel) and plot no- 1690,1691,1695,1696,1697

With total area -13.5 acre

Year of establishment 1978

## **3. Mode of survey**

- a) Pond- 90'x80'x6'
- b) General garden
- c) Greenies around pond
- d) Ladies Hostel campus Plantation

## **4. Study of Pollution**

- Science laboratory- chemistry laboratory of this college releases so<sub>2</sub> (No)<sub>x</sub> co<sub>2</sub> etc.
- Vehicular pollution- more than 1000 two wheelers, four wheelers coming to the daily.
- BCR, GCR, SCR, office of this college release pungent odour having on NH<sub>3</sub>.
- A number of vehicles pass through the nearby salt road which causes air pollution.

## **5. Other difficulties**

- Our college is very prone to cyclones, flood in each year. So number of plants are uprooted or dwindled.
- College is only 10 km away from seashore.
- A salt road passes near to the college. so vehicles release air pollutants which enter into college campus.

### **Remedial measures**

Waste management: - The official wastes like cartons, waste paper, fallen leaves, cow dung are collected and dumped into a pit. These are biologically degraded, the humus is collected and used in garden and Plantation

### **College Garden**

To beautify the campus diff. Type of medicinal plants, flowering plant are planted. Seasonal flower are also planted in each seson. thePermanent flowering plant are croton, Arcania, pasiflora, peniwinkle, henna, Jasmine, gardenia, chamap jasmine cycas, might jasmine, rose etc.

### **Plantation in Subhdra Ladies hostel**

There is special focus for plantation in subhadra womens hostel in this year.

The following plants have been planted. these are Bakul, Pesta badam, guava

### **Future Plane**

Different type of plant are to be planted around the playground and also in Subhadra ladies Hostel.

### **Azolla Culture**

In the Subhadra women's hostel an Azolla culture take has been set up Azolla is a very good N<sub>2</sub>fixen. It is also used for feeding of domestic animals.

### **Appraisal report**

Audit is done by Eco club established in the Depart Botany. The durability is one year in normal condition

## Green Population study

Name	Full grown	Young	Sapling	Uprooted	Total
Acacia	140	10	10	05	165
Bakul	20	20	00	00	40
Jamun	03	00	00	00	03
Sinisha	07	00	00	00	07
Betelnut	07	03	00	00	10
Paper plant	02	00	00	00	02
Neen	50	10	00	00	60
Kanchan	01	00	00	00	01
Sik Cotton	07	00	00	06	13
Radhachuda	10	02	01	00	13
Arjun	03	00	00	00	03
Batapi	-	01	-	-	01
Chhagalbati	01	-	-	-	01
Coconut	04	-	-	-	04
Red wood tree	08	-	-	-	08
Banyan	00	01	-	-	01
Jui	02	-	-	-	02
Mango	18	03	02	-	23
Sapota	08	01	-	-	09
Margosa	00	03	-	-	03
Champak	02	-	-	-	02
Nageswar	01	00	00	00	01
Debadaru	57	00	07	-	64
Guava	04	02	-	-	06
Muchakund	01	-	-	-	01
Tamarind	01	-	-	-	01
Janglibadar	01	-	-	-	01
Teak	30	00	27	-	57
Euqualiptes	10	01	-	-	11
Arcania	03	-	-	02	05
Palmyra palm	06	00	-	-	06
Prunus	-	03	-	-	03
Diospyros	-	01	-	-	01
Buanla	13	02	-	-	15
Karuna	00	01	-	-	01
Chachina	01	-	-	-	01
<b>Total</b>	<b>431</b>	<b>42</b>	<b>58</b>	<b>05</b>	<b>536</b>

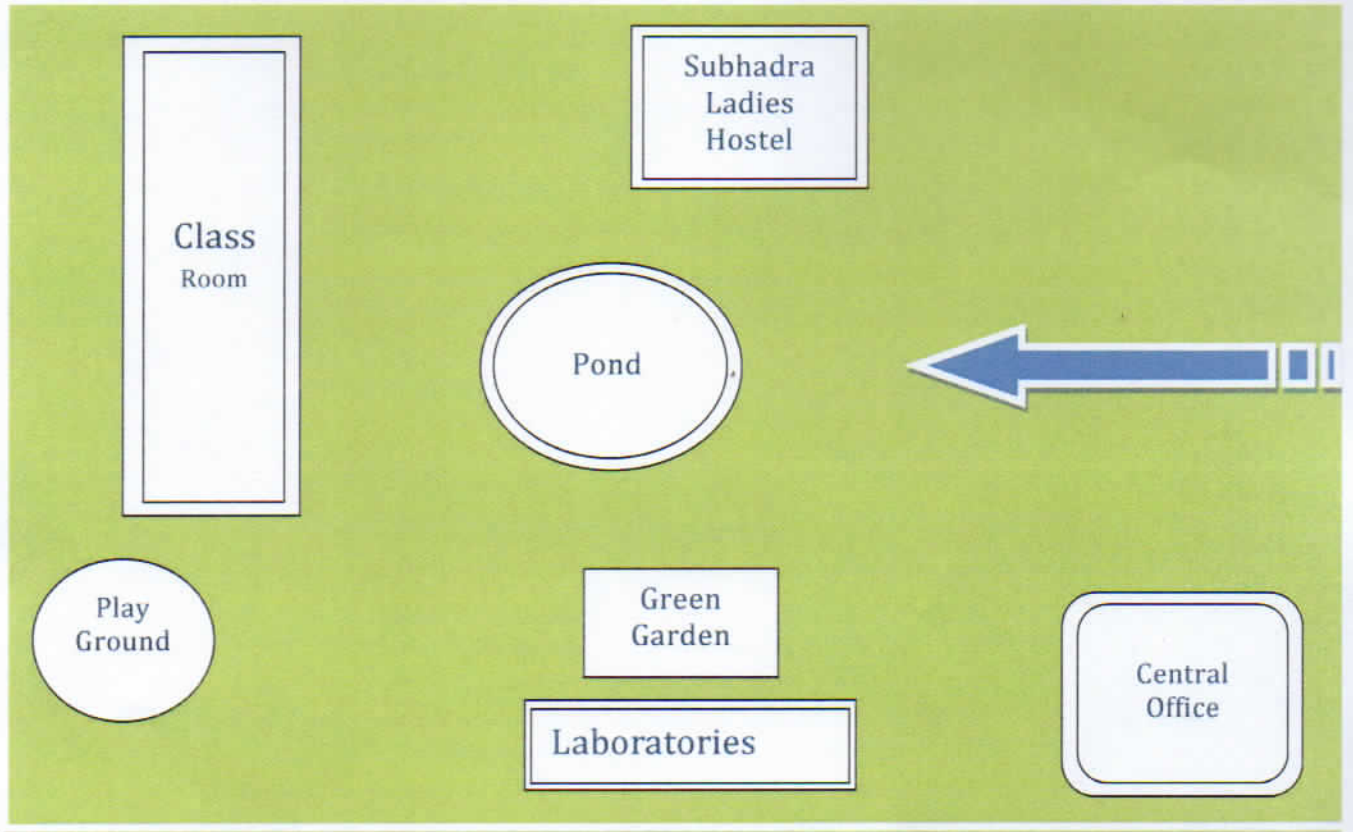

*Umesh K Panigrahi*  
 Signature of *9.5.18*  
 Green Audit Officer

*Nand Kishore Patra*  
 Principal *9/05/18*  
 Gopalpur College, Gopalpur, Balasore  
 Gopalpur College  
 Gopalpur, Balasore